

Technical drawing of a building facade and floor plan. The top part shows a facade elevation with horizontal dimensions (980, 990, 1440, 960, 1340, 2565, 1100, 2400, 2440, 1000) and a vertical dimension of 2.79 m. The middle part shows a floor plan with various rooms and dimensions. The bottom part shows a side elevation with vertical dimensions (0.10, 0.10, 0.32, 0.65, 0.60, 2.79, 3.49, 0.32) and horizontal dimensions (300, 400, 500, 550, 500, 500, 1700, 1750, 500, 400, 750, 600, 500, 2750).

Technical drawing of a building section showing a cross-section of a room with a door and a ceiling. The drawing includes dimensions for the room height (2.79 m), door height (2.13 m), and various offsets (0.15, 0.10, 0.32). The ceiling is labeled "L.H. Abhangdecke 2.79 m". The drawing is oriented horizontally, with the door opening to the right.

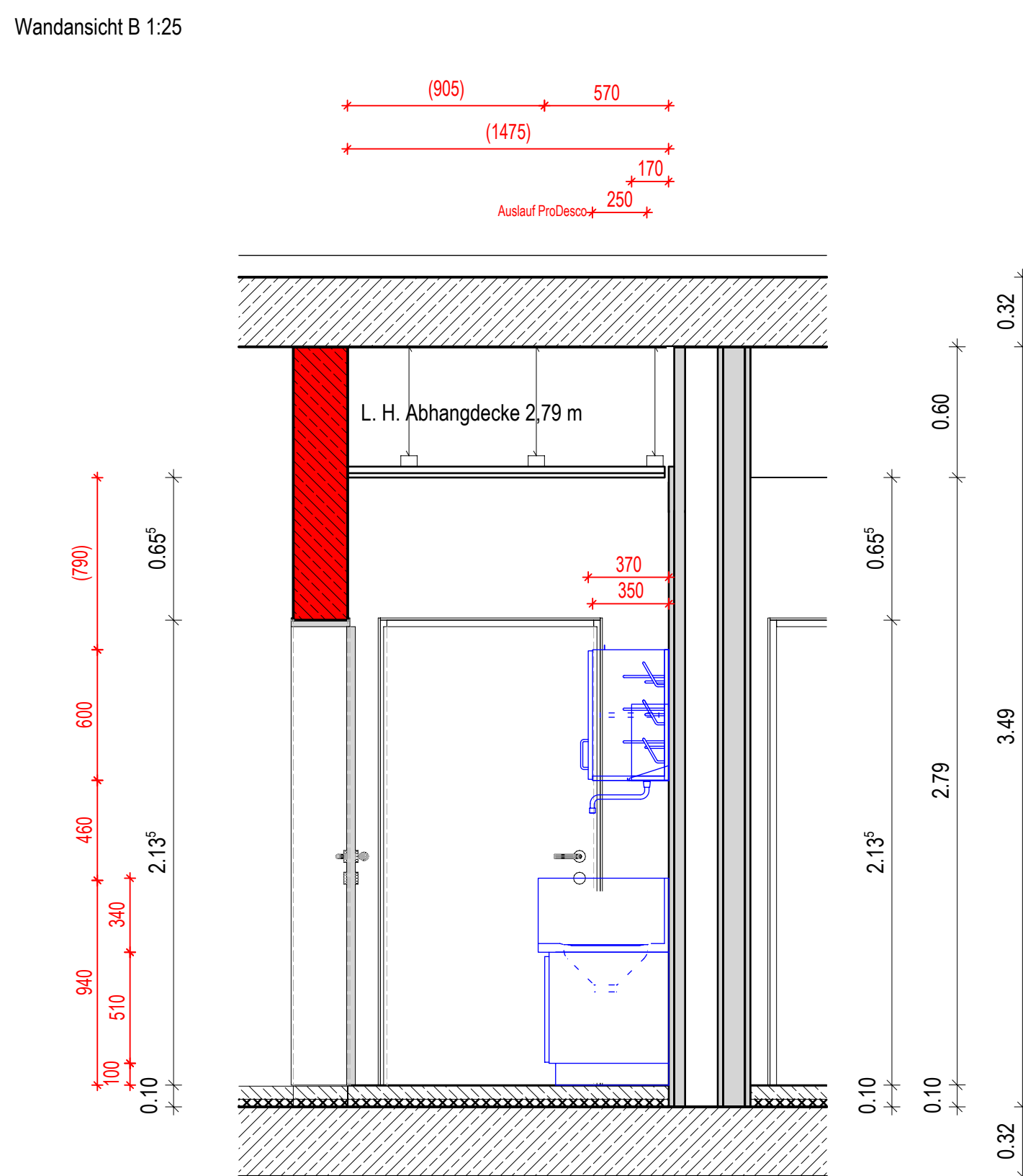

Wandansicht D 1:25

[illegible]

DATUM, UNTERSCHRIFT BAUHERR	DATUM, UNTERSCHRIFT ARCHITEKT	DATUM, UNTERSCHRIFT
-----------------------------	-------------------------------	---------------------



AUHERR: Uniklinik Südostbayern uno-Niggli-Strasse 3 80278 Traunstein	ARCHITEKT: LUDES ARCHITEKTEN - INGENIEURE GMBH BEETHOVENPLATZ 4 80336 MÜNCHEN TEL.: 089 / 9292777-0 FAX: 089 / 9292777-20	FACHPLANUNG:
---	---	--------------